

*An introduction to our
new community venue*



Welcome to St. Peter's Church Annexe
and Next Door Hextable
Thank you for your care, participation and
generosity in realising the unfolding vision for
this corner of NW Kent. We're so
glad to share it with you...

Next Door Hextable: our community cafe
Wednesday-Saturday, 9am-to-4:30pm
www.NextDoorHextable.org.uk
#NextDoorHextable

www.stph.org.uk

*hospitality,
creativity &
welcome*

NEXT DOOR HEXTABLE,
COLLEGE ROAD / MAIN ROAD,
HEXTABLE BR8 7RH

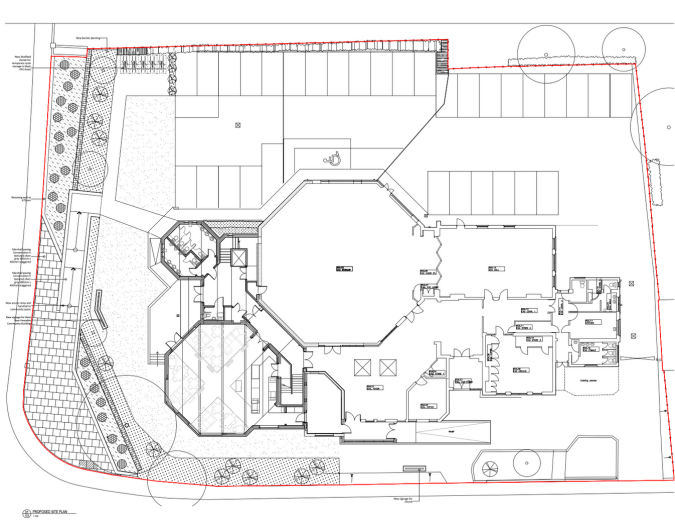

The Annexe was a building project conceived in 2003 in response to a need for more community space in the village and a place for people to meet and socialise. Nineteen years later, despite many challenges on the way, this vision has become a reality, realising the possibility of a centre for hospitality, creativity, and welcome. The café and community centre walls are also hosting the work of local and national artists, who will join up with our schools to talk about their art and inspiration, promoting creativity in our young people. Our vision is that everyone will be welcome and feel included in God's love and care for all, regardless of faith, conviction, age or stage of life.

Our Next Door Hextable Café is open four days a week presently, Wednesday to Saturday, 9 am to 4.30pm, serving breakfasts, lunches and cakes with excellent coffee! It can seat fifty-four indoors with an additional ten outside on the patio. Since the first few weeks of trading, it has proved a great success in our community, with many on their third or fourth loyalty card, enjoying each seventh drink free. We welcome 190-360 people each trading day, serving Kent provenance wherever possible.

The cafe space is 121m² in the overall 414m² site development. People have remarked on its convenience in the centre of the village, with parking; its spaciousness, outlook, lightness, variety of seating arrangements and table formations, serving such a variety of needs. It provides a distinctive and unique place where people can meet and relax in our locality. The café offers a warm, friendly, and inviting atmosphere, where there's always a real 'buzz'. It's a place for children and families, older people, groups, the lonely, those who just want to sit and chat and for some who value 'working away from home'. It's a place where people can find care and support or where young children can rummage in the toy box while the adults dig into cake and coffee! It realises our vision of being accessible, affordable and appreciated. For all, it's a place of hospitality and welcome.

The Upper Room is a large, spacious, bright meeting room with excellent views over the village and is ideal for dance groups, art workshops, and larger meetings. It reflects an octagonal design which can host up to 110 people seated or 140 standing.

The Chapel is a smaller comfortable space with seating for small meetings and groups. It is currently host to 'The Messenger', a large-scale painting by Rebecca Hind, on kind loan to us. For this work, the artist took inspiration from the annunciation story in Luke 2:19, "But Mary kept all these things, and pondered them in her heart." This space is ideal for groups of up to twenty-eight.

With the kitchenette and toilet provision, our venue provides flexible zoned usage to serve many individuals, households and groups for the flourishing of our communities.

New additional chairs are being finalised across our site to enhance the quality and enjoyment for all. With core staff and a growing volunteer team of over thirty, we are growing into the space and place as we discover what best works and doesn't in the particularities of our localised needs, place and time. In the remainder of our College Road-Main Road site, the old Schoolhouse and flexible church worship spaces are a mix of other spaces that work well to serve, welcome and resource many parts of our community in their difference and commonality. Further works and redevelopment of these are planned over the coming months.

Just as we nurture the beautiful landscaping and planting, with other memorial benches coming, we anticipate much future partnership and community possibilities in the wise stewardship of this unique space, welcoming and resourcing help for all who come this way.

Next Door Hextable exists to increase hospitality, nurture creativity and extend welcome in this corner of NW Kent.
www.NextDoorHextable.org.uk

#NextDoorHextable

